

DUNA LO

320RA01L11



Descrizione del prodotto / Product description

Incasso LED per interni ed esterni

Corpo realizzato in tornitura di alluminio con trattamento superficiale di anodizzazione nera.

Flangia superiore in Acciaio Inox AISI316L o Bronzo Naturale.

Ottica ad emissione spot in PMMA trasparente.

Lente superiore tornito in PMMA trasparente.

Pressacavo posteriore IP68.

Power LED di potenza ad altissima efficienza CRI ≥90.

Cavo di collegamento in neoprene. Fornito con sistema di connessione rapida termoretraibile (vedi istruzioni di montaggio).

LED projector for indoor / outdoor.

Body made of turning aluminum with black anodized treatment.

Upper flange made of Stainless Steel AISI316L or Natural Bronze.

Spot optics made of clear PMMA.

Upper lens made of turned clear PMMA.

Rear co-printed cable gland IP68.

Power LED with very high efficiency CRI ≥90.

Neoprene connection cable.

Supplied with heat shrink fast connection system (see assembly instructions)

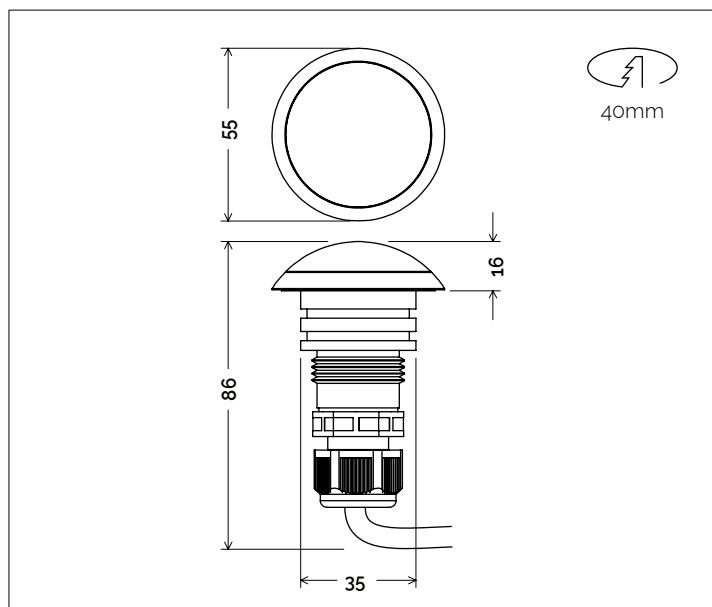

Dati tecnici | Technical Info

* su richiesta / on requests

Finiture Finishes	1002 Acciaio Inox AISI 316L I Satin Stainless Steel AISI316L
	1012 Bronzo Naturale Natural Bronze
	Verniciati RAL I RAL Paintings*
Potenza Power	3W
Corrente Current	-
Tensione Voltage	24Vdc
Tolleranza cromatica Chromatic tolerance	3 SDCM
Flusso luminoso Luminous Flux	236lm
Mantenimento del flusso lumi- noso Flux Maintenance	≥50.000h
Temperature di esercizio Ope- rating temperature	-20° ~ 45°

Simbologia tecnica Technical informations

	Conforme alle direttive CE
	Conforme alle normative RoHs
	Classe III
IP65	Indice di Protezione IP65
	Connettore stagno in dotazione

Temperatura di Colore Color Temperature

9027 - 2700K CRI 92
9030 - 3000K CRI 92
9040 - 4000K CRI 92

Ottiche Optics

	N1 -8° (Very Narrow Beam)
	N4 -15° (Narrow Beam)
	F1 -30° (Flood Beam)
	W1 -45° (Wide Flood Beam)
	E1 -15°x45° (Elliptical Beam)

Sistemi di Controllo Control System

	On / Off (remoto escluso / remote excluded)
PUSH	Push * (remoto escluso / remote excluded)
1-10V	1-10V , 0-10V * (remoto escluso / remote excluded)
	DALI * (remoto escluso / remote excluded)

Creazione Codice | Code construction

320RA01L11-XXXX-XX-XXXX

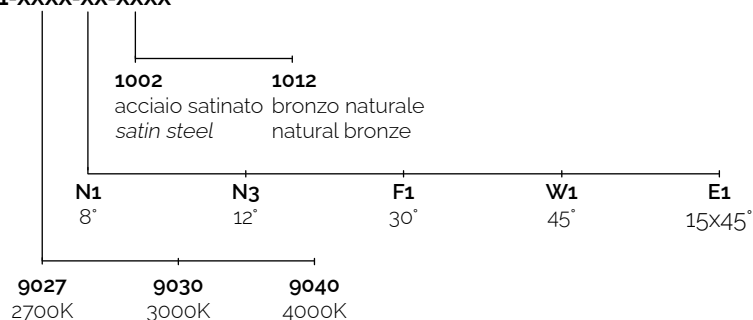

Dati Fotometrici | Photometric Specification

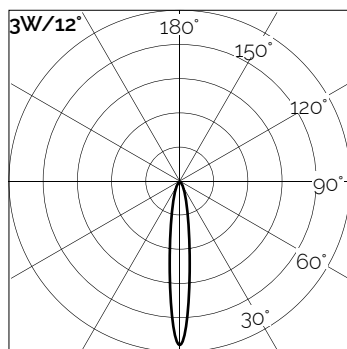

h (m)	E (lx)	D (cm)
1	2660	21
1.5	1134	31
2	695	42
2.5	425	52
3	303	63

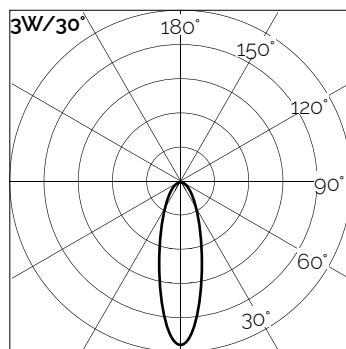

h (m)	E (lx)	D (cm)
1	646	53
1.5	285	80
2	160	107
2.5	103	133
3	71	160

Accessori | Accessories

9A001

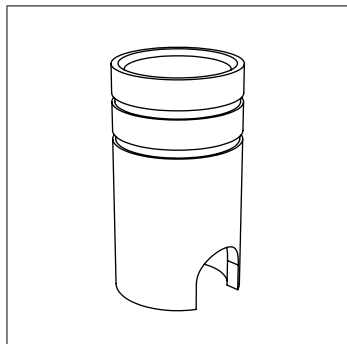

Cassaforma per incasso
(Ø44mm H.80mm)

Recessed Box
(Ø44mm H.80mm)

9A002

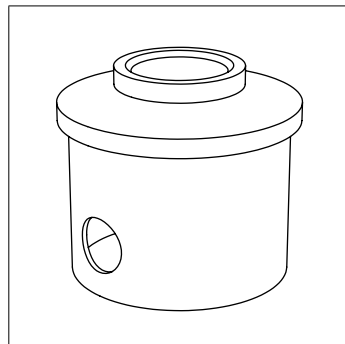

Cassaforma maggiorata per
incasso
(Ø90mm H.80mm)

Large Recessed Box
(Ø90mm H.80mm)

9A003

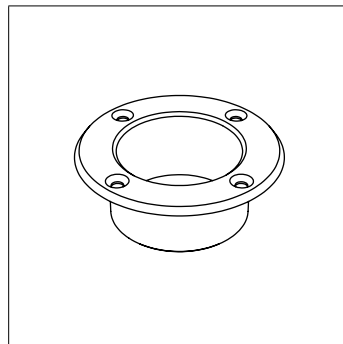

Cassaforma per pannello.
foro Ø42mm (flangia Ø58,8 x
22mm)

Recessed Box for panel
hole Ø42mm(Ø58,8 x 22mm)

9F005

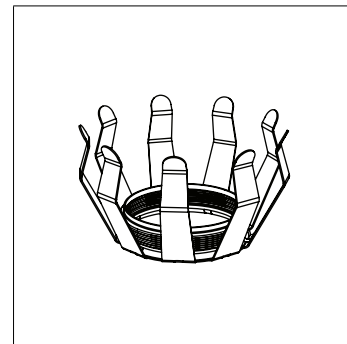

Molla di fissaggio.
(foro su pannello Ø40mm)

Fixing Spring.
(hole on panel Ø40mm)

Alimentatori | *Led Driver*

Tipo Alim. / Driver Type	potenza / power	tensione / voltage	dimensioni / dimensions	n. prodotti	IP	codice / code
ON/OFF	10W	24Vdc	39x22x75mm	1 ~ 3	20	9M301
	14W	24Vdc	38x25x79mm	1 ~ 4	67	9M401
DALI	-	24Vdc	35x53x150mm	1 ~ 18	67	9M805